

HSR Brooklyn

3230 SE Milwaukie Avenue
Portland, OR 97202
W.P.A Job Number 1318

© 2020 Works Progress Architecture, LLP
ALL RIGHTS RESERVED

All drawings are the property of Works Progress Architecture LLP and are not to be used or reproduced in any manner without prior written permission.

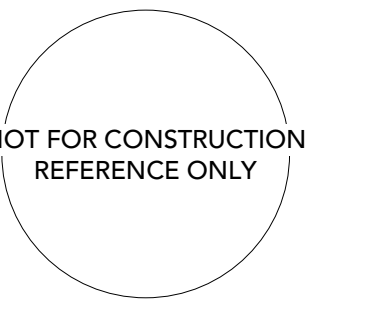

100% Schematic Design 07/15/20

SET ISSUE

Architectural
Site Plan -
Proposed

g0.05

Property Info:

Project Address: 3230 SE Milwaukie Ave

Property / Lot Area: 30,000 sf
Existing Building Footprint: 7,956 sf
Existing Building Coverage: 27%

Proposed Building Footprint: 18,264 sf
Proposed Building Coverage: 61%

Impervious Area:

Existing Hardscape: Approx. 18,380 sf
Existing Impervious Area: Approx. 26,336 sf

Proposed Hardscape: Approx. XX sf
Proposed Impervious Area: Approx. XX sf

Total Proposed Impervious Area: XX sf
Total Proposed Pervious Area: XX sf

Site Plan General Notes:

- Contractor To Verify Existing Utility Locations Prior To Construction. Typ.
- Provide erosion control per civil.
- Reference Roof Plan For Storm Drain Locations
- Reference Foundation Plan For Under Slab Utility Locations
- Water Meter and Connections to Main By _____
- Gas Meter Placement by _____
- Re: Civil for Stormwater Management Systems

Legend: Site Plan Symbols

—	Property Line
- - -	Fence
- - - - -	Building / Wall to Be Demolished
- - - - -	Curb Line
- W - W - W	Water Line
- SS - SS - SS	Combined Storm/Sewer
- S - S - S	Storm Line
- STM - STM - STM	Sanitary Sewer Line
- G - G - G	Underground Gas Line
- OH - OH - OH	Overhead Power Line
- P - P - P	Underground Power Line
○	Storm Catch Basin
○	Manhole
○	Power Pole / Light Pole
○	Light Pole
○	Sign
○	Fire Hydrant
○	Water Meter
EM	Electric Meter
GM	Gas Meter
◻	Property Corner

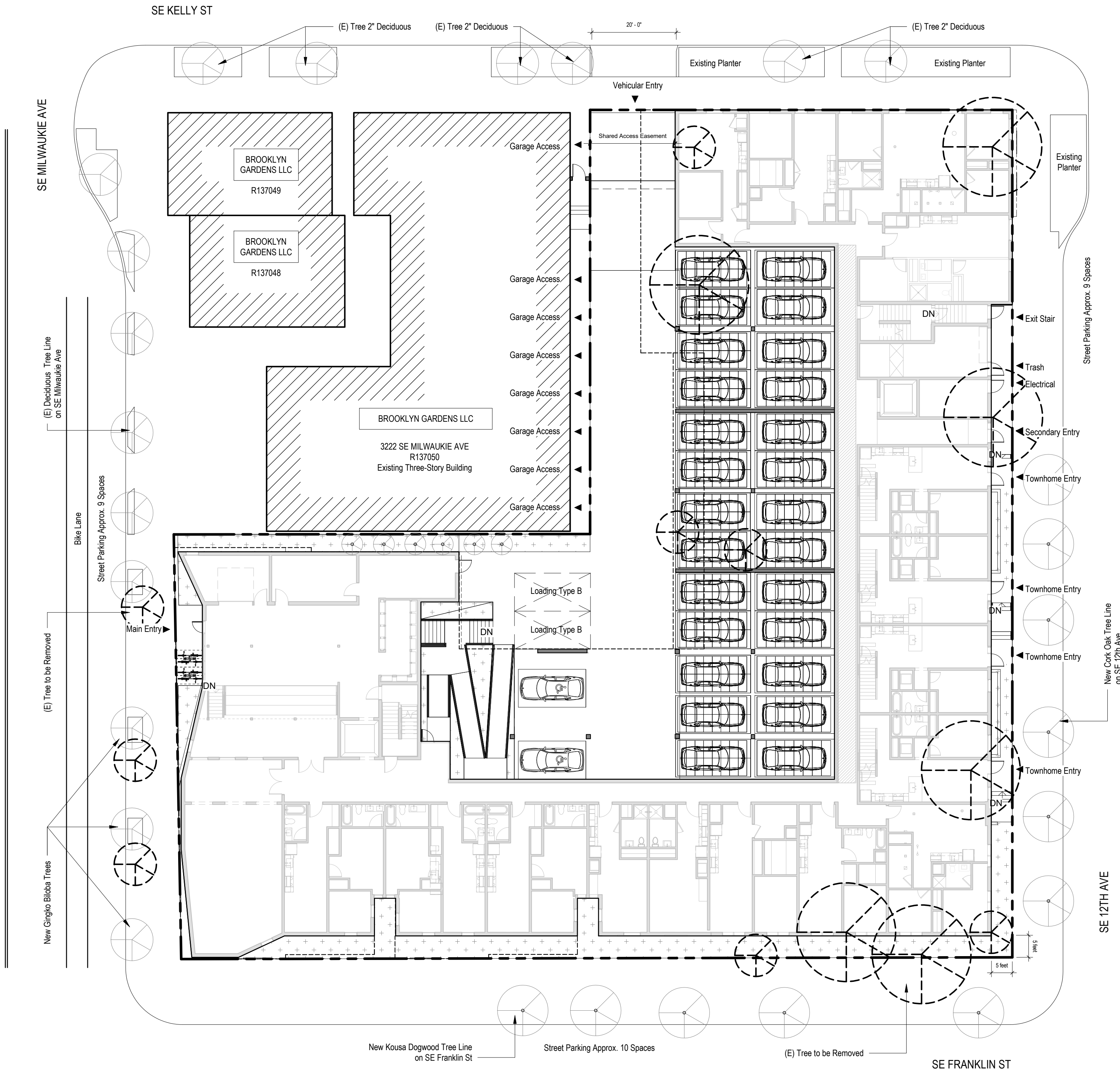

1 Site - Proposed
1/16" = 1'-0"